

# Next Steps



CAPITAL  
CAMPAIGN



# Introduction

In 1954, the Covenant churches in the Twin Cities came together and created a camp so kids could have a fun Christian camp experience. The existing Chapel at Covenant Pines Bible Camp was built three years later in 1957.

For generations, the Chapel has served as a space of spiritual nourishment, growth and calling. If you look closely, the fingerprints of the volunteers line the ceiling boards...a reminder of the many prayers offered as the Chapel was built and dedicated.

After serving us well for decades, it is now time to replace our beloved Chapel. The deteriorating condition of the Chapel is moving us to action.

The chapel is sacred space for so many who have made next faith steps within the walls. With that in mind, decisions regarding the existing chapel will be made in the upcoming years. No plans are imminent.



*Our Chapel has served as a space of spiritual nourishment, growth and calling.*



*Our beloved Chapel built in 1957*



*Outdoor worship in the amphitheater.*





# Our Needs

The Chapel was built over 60 years ago and it has structural issues because of its age. The chapel wasn't built for camps our size which means pews are cramped as campers sit too close together. During the summer, the Chapel gets very hot despite our best efforts to keep it comfortable. Because there is no running water, a trip to the bathroom for a camper can take over 15 minutes due to the distance to the closest bathroom.

The retreat season, between September and May, is an important part of our ministry. On average, we host 57 retreats per season. The Chapel cannot be used during the winter because it isn't insulated. Instead, many groups choose to worship in Oakridge dining hall. This space makes for a poor worship experience because of the acoustics.

We don't have a space large enough for groups of 300 people to worship during the winter, so we turn groups away which cuts into both our ministry impact and registration income.

Imagine campers and retreat attendees missing opportunities to take their next step in faith because of distractions caused by spaces that aren't designed for worship or are too crowded, too hot, too noisy, or too far from the bathroom.



*Our 64-year-old Chapel has structural issues.*



*The deteriorating condition of the Chapel is moving us to action.*

---

“As a youth pastor, retreats at Covenant Pines are golden opportunities for me to grow deeper in my relationships with students. Since the camp staff takes care of the programming details, I get to give my full attention to simply being present, and investing my energy in quality time with kids-- which is often where the most important moments and life-altering conversations happen! When our group spends a weekend at camp, we come away closer to one another and to God, ready to take the next steps of faith in our daily rhythms. Retreats at CPBC are a HUGE asset to our ministry!”

**- Anna Maloney, Pastor of Student and Family Ministries,  
Bloomington Covenant Church**

---

# Our Plans

The proposed Worship Center will meet both our current summer camp needs and future retreat needs.

The Worship Center will seat 300 people comfortably with a beautiful view of the woods. We will have movable chairs so that we can easily break into smaller groups. It will have running water and bathrooms.

It will be fully insulated and have adequate climate control so that we can serve campers and retreat attendees year-round in a comfortable environment. It will also allow us to host more retreats in the winter.

This not only allows us to encourage more campers in the next step of their faith journey, but will also help us utilize our facility better and increase our revenue stream year-round.

For decades, the chapel experience has been the number one rated activity at camp. It is the “heart of camp.” The proposed location of the Worship Center will physically represent the “heart of camp” with its location near the middle of our property. We are prohibited from rebuilding on the current site of the Chapel, due to shoreline setback requirements.



*Architect rendering of the front of the new building with our existing trees as seen from the playground.*

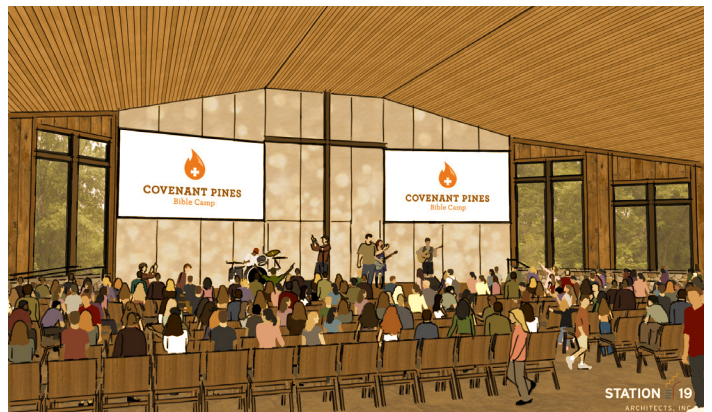

*Architect rendering of the Worship Center. The view out the windows show our existing trees in that location. The Worship Center will feel like it belongs at camp--note the wood paneling on the walls and ceiling. The windows are raised to prevent campers from seeing anyone walking in the woods behind.*



*Architect rendering of the Commons.*



While the primary function of the building is to provide a sacred worship space for campers, the new building will have the added benefit of providing a relocated office space making it easier for campers to know they've arrived and find where to register.

The office, which receives many deliveries each day, will be located in a place away from where kids run and play. This new location will greatly limit the amount of outside traffic past the offices which will increase safety for our campers.

The building will also have a Commons for campers to gather during the day or prior to worship. In essence, it will be a ministry hub at the center of camp.



*The Worship Center and registration will be located in the heart of camp--easier for visitors to know they've arrived. Daily deliveries will be away from where kids run and play.*

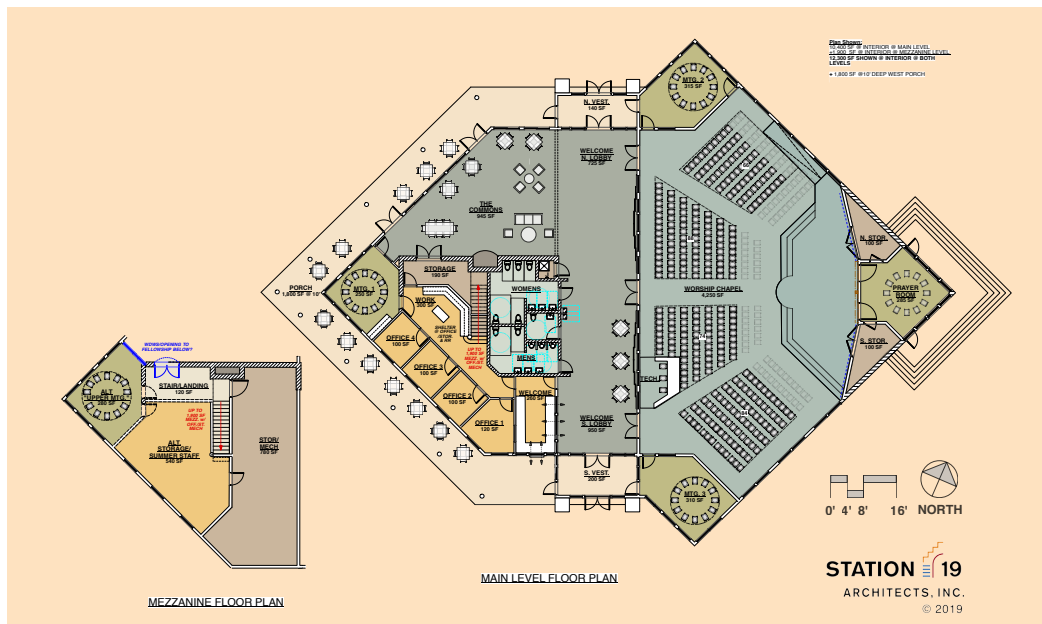

# Budget

In February 2019, we contracted with an architect to determine the scope and costs of this project and determined that it would cost \$4.1 million to accomplish our dream of a new worship space. COVID-19 has increased the costs of our new building plans to \$4.5 million.

We began fundraising in late 2019. Then in 2020, after we had raised \$682,000 in cash/pledges, we decided to pause our fundraising efforts because of COVID-19.



# Moving Forward

To raise the needed money, we are resuming our Next Steps campaign and asking people to make a three-year financial pledge over and beyond their regular gifts to camp.

Our Minimum Goal of \$3.5 million enables us to build the Worship Center with some financing.

Our Challenge Goal of \$4.5 million enables us to build the Worship Center with no anticipated long-term financing.

In order to reach our goals, we need many gifts, some of them substantial.

## \$3.5 Minimum Goal

NUMBER OF GIFTS NEEDED	SIZE OF GIFT	TOTAL AMOUNT
1	\$500,000	\$500,000
2	\$250,000	\$500,000
4	\$100,000	\$400,000
12	\$50,000	\$600,000
20	\$25,000	\$500,000
48	\$10,000	\$480,000
Many	Up to \$10,000	\$520,000
Total		\$3,500,000

## \$4.5 Challenge Goal

NUMBER OF GIFTS NEEDED	SIZE OF GIFT	TOTAL AMOUNT
1	\$600,000	\$600,000
2	\$300,000	\$600,000
4	\$150,000	\$600,000
8	\$75,000	\$600,000
8	\$50,000	\$400,000
24	\$25,000	\$600,000
50	\$10,000	\$500,000
Many	Up to \$10,000	\$600,000
Total		\$4,500,000



# Three Ways to Give

## Giving more than you thought you could

There are three great ways to give. First, you can make a **pledge over three years**. This is the way most people are able to make a significant donation. Even modest amounts become significant when given monthly or with each paycheck over three years.

All gifts are given over and above your regular gifts to camp. Pledges can be paid annually, semi-annually, quarterly, monthly or with each paycheck. Please consider an initial payment of 10% at the time of your pledge.

Next, you can make a **non-cash gift**. This might be gifts of stock; land or property; valuable possessions such as jewelry, automobiles and antiques; or even in-kind gifts such as supplies

and labor. The ownership of these gifts will be transferred to Covenant Pines Ministries. We will sell these gifts and use the cash to fund the building campaign.

Finally, you can make a **legacy gift**. Through a charitable bequest in your will or living trust, you can leave a legacy that will continue for years to come. This thoughtful act, which has little or no current financial impact on you, may result in the largest and most lasting one-time gift you will ever make to Covenant Pines Ministries. While this legacy gift may not immediately impact our current needs, it will provide for needs in the years to come.

## Conclusion

By 2035, our goal is to double the number of youth and adults at Covenant Pines Bible Camp to 14,000 people each year, and encourage each one of them to take a Next Step in Christian faith. Most of our growth opportunity is during the retreat season.

The new Worship Center at Covenant Pines Bible Camp creates the sacred space needed to reach this ministry goal. To do this, we need your prayers and your generous giving. Join us in these Next Steps.





# Three-Year Payment Plans



GIFT LEVEL	TOTAL GIFT	(10%) INITIAL INVESTMENT	(36) MONTHLY	(12) QUARTERLY	(6) SEMI-ANNUALLY	(3) ANNUALLY		
Pacesetter	\$750,000	\$75,000	\$18,750	\$56,250	\$112,500	\$225,000		
	\$600,000	\$60,000	\$15,000	\$45,000	\$90,000	\$180,000		
	\$500,000	\$50,000	\$12,500	\$37,500	\$75,000	\$150,000		
	\$300,000	\$30,000	\$7,500	\$22,500	\$45,000	\$90,000		
	\$250,000	\$25,000	\$6,250	\$18,750	\$37,500	\$75,000		
	\$150,000	\$15,000	\$3,750	\$11,250	\$22,500	\$45,000		
	\$100,000	\$10,000	\$2,500	\$7,500	\$15,000	\$30,000		
	\$75,000	\$7,500	\$1,875	\$5,625	\$11,250	\$22,500		
Advanced	\$50,000	\$5,000	\$1,250	\$3,750	\$7,500	\$15,000		
	\$40,000	\$4,000	\$1,000	\$3,000	\$6,000	\$12,000		
	\$30,000	\$3,000	\$750	\$2,250	\$4,500	\$9,000		
	\$25,000	\$2,500	\$625	\$1,875	\$3,750	\$7,500		
	\$20,000	\$2,000	\$500	\$1,500	\$3,000	\$6,000		
	\$15,000	\$1,500	\$375	\$1,125	\$2,250	\$4,500		
	\$10,000	\$1,000	\$250	\$750	\$1,500	\$3,000		
	\$5,000	\$500	\$125	\$375	\$750	\$1,500	DAILY	WEEKLY
Community	\$4,000	\$400	\$100	\$300	\$600	\$1,200	\$3.29	\$23.08
	\$3,000	\$300	\$75	\$225	\$450	\$900	\$2.47	\$17.31
	\$2,000	\$200	\$50	\$150	\$300	\$600	\$1.64	\$11.54

